

SuperFlow360

real milking jewel



AGRI PATRIA
Factory of milking equipment

t: +48 22 355 32 26
m: +48 608 877 804
e: info@agripatria.com



STANDARD CLUSTER

Claw SF360 + short round liner type Gea Westfalia* type Milkrite*

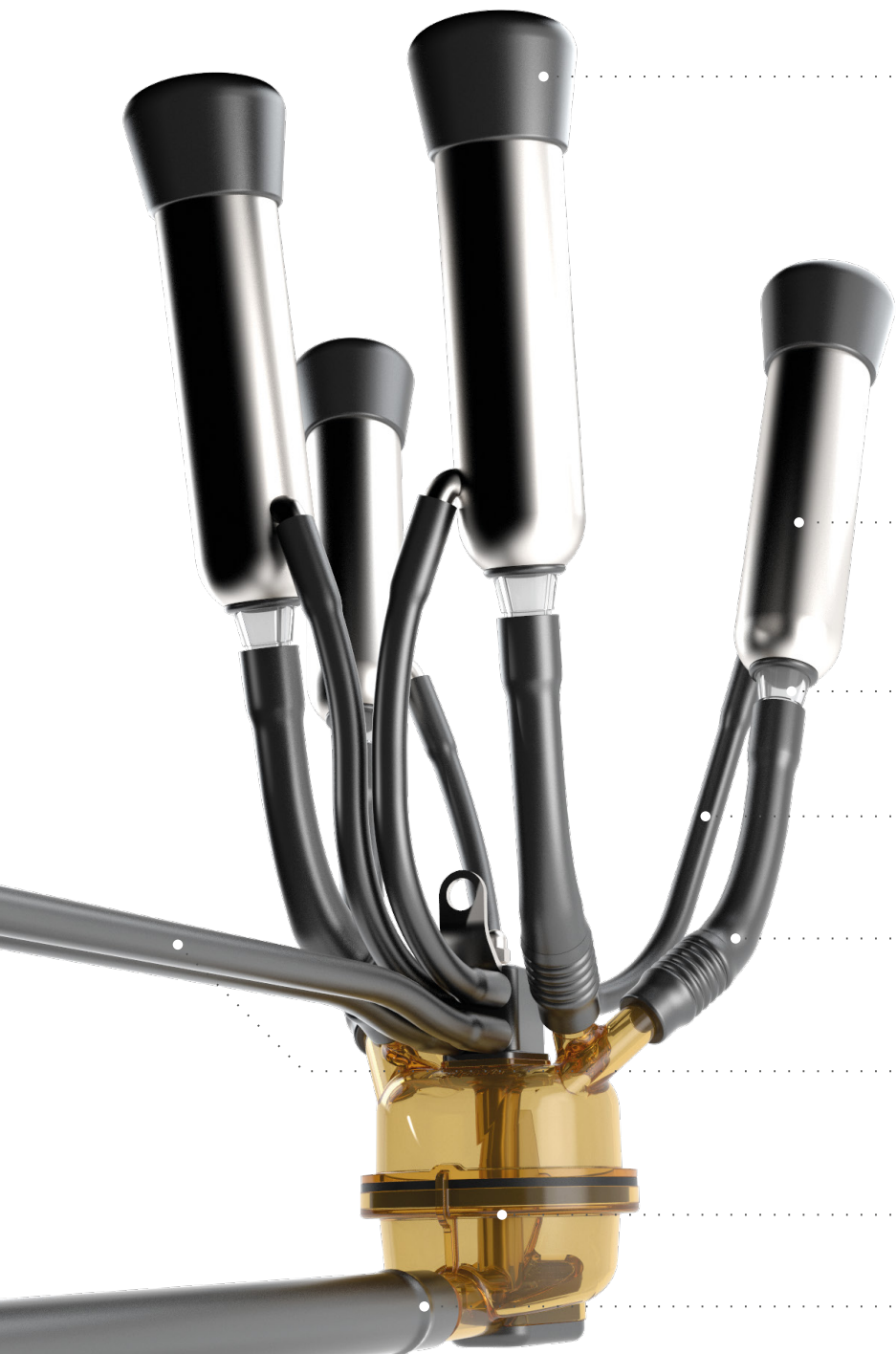

Round liners

7022-2725-150
7022-2725-220
7022-2725-230
IP14U or IP14U-Air
IPS10U - SILICON LINER

Stainless steel shells

size: 44 x 27 x 147 mm
Special shell and ring

Glass connector

Short air tubes

Short milk tubes

Twin pulse tube
recommended: Ø 7 x 14 mm

Claw SF360

Milk tube
recommended: Ø 16 mm

✓ ANATOMICAL FITTING

An anatomical fitting arrangement of claw's & vacuum distributor nozzles to the cow's udder.

SF360AF

SF360
standard

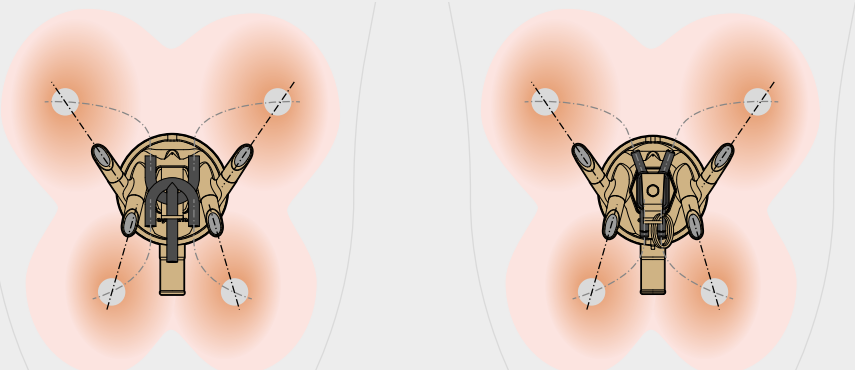

STANDARD CLUSTER

type Gea Westfalia* type Boumatic* type Milkrite* Claw SF360 + mono block round liner

Round liners

7021-2725-270
FLEX 50
DK1X
IP14U or IP14U-Air

Stainless steel shells

size: 44 x 27 x 147 mm
size: 50,8 x 19 x 140 mm
size: 42,5 x 19 x 140 mm
Special shell and ring

Short air tubes

Twin pulse tube
recommended: Ø 7 x 14 mm

Claw SF360

Milk tube
recommended: Ø 16 mm



✓ GREATER OPPORTUNITIES - COMFORT

SF360AF allows for more comfortable work. The compact vacuum distributor is made of nylon in the construction enabling both **alternative milking** (forward - backward) and **simultaneous**. By applying different frequencies during alternative milking, you can get different milking speed of the

front and rear quarters. When milking simultaneously, the pressure drops during massage, similar to the natural feeding of the calf. Thanks to the increased capacity and efficiency of milk collection, the collector provides a full vacuum canister ready to receive the next portion of milk.

* References to other manufacturers by their company names, trademarks or product references are for identification purposes and are used only to indicate the intended purpose of Agri Patria products and their compatibility with the equipment of those manufacturers

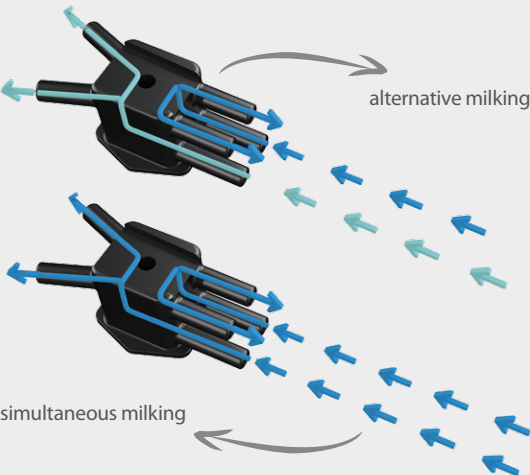

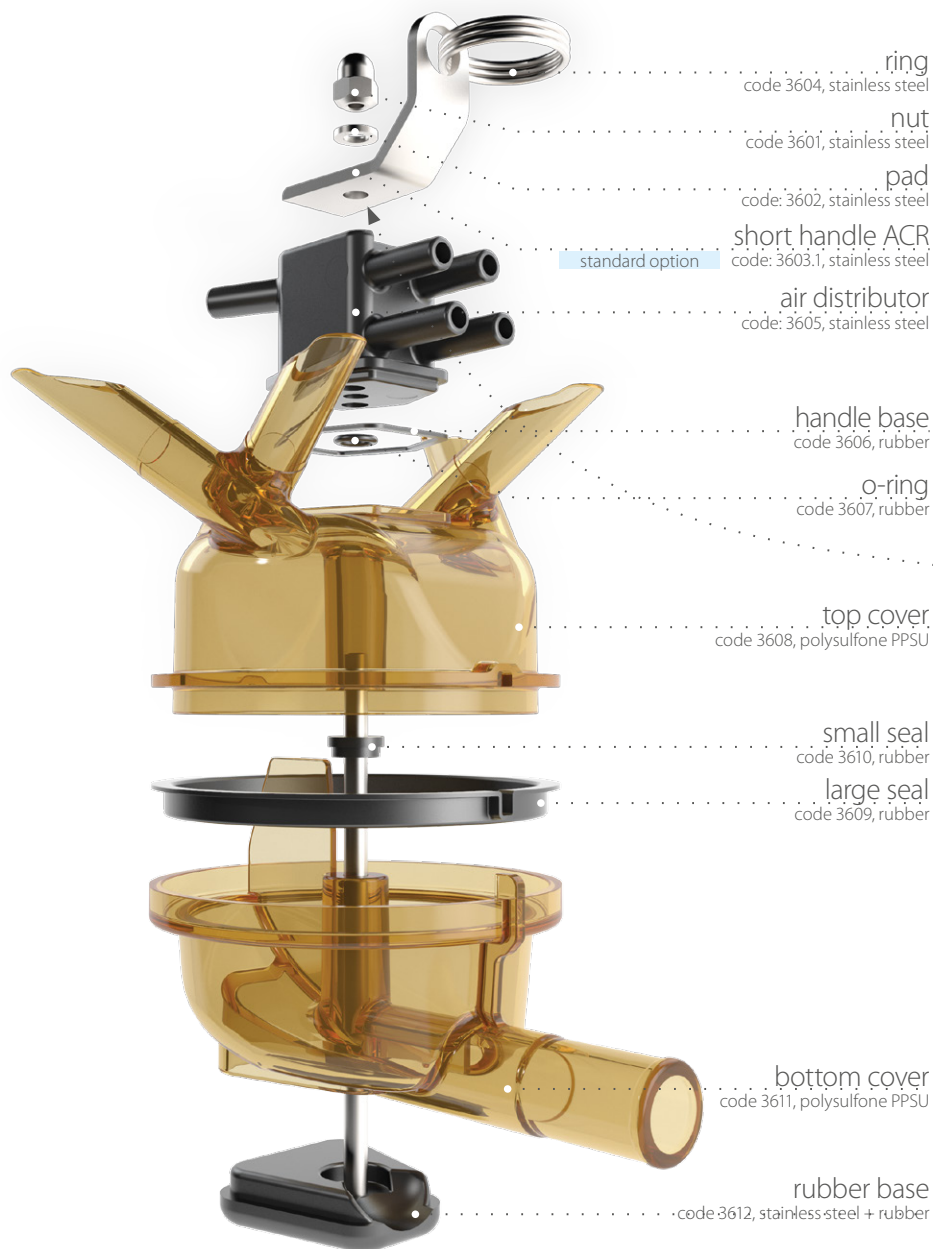

SF360

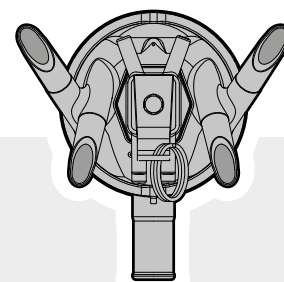
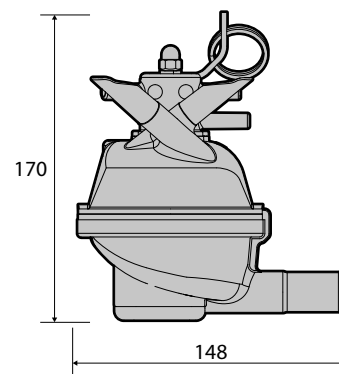
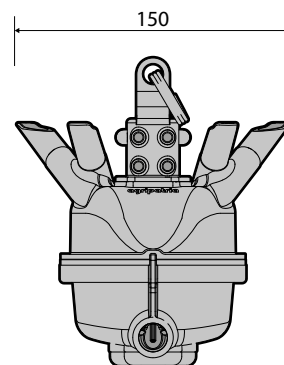

TECHNICAL DATA SF360

capacity	360 ml
weight	358 g
material	polysulfone Radel PPSU
vacuum drop	+/- 0,2 kPa
flow at 42 kPa	20 l/min
outlet ID	Ø 16 mm
nipples inlet OD	Ø 14,5 mm
nipples shape	diagonal cut
nipples angle	45°
shut-off	without valve
bracket	ACR
pulsation cross	front/rear

TUBES

short air tube	7 mm x 14 mm
twin pulse tube	7 mm x 14 mm or 8 mm x 16 mm
milk tube	16 mm x 27 mm

Materials used in the manufacturing process have necessary attestations and hygienic clearance certifications allowing the product to contact milk. More information: www.agripatria.com/support
SF360 is not authorised for sale in: AU, BE, CA, DE, ES, FR, GB, IE, IT, JP, MX, NL, NZ, SE, US

